

LED AREA LIGHT

SE7100/600, SE7100/900 POWERSTAR

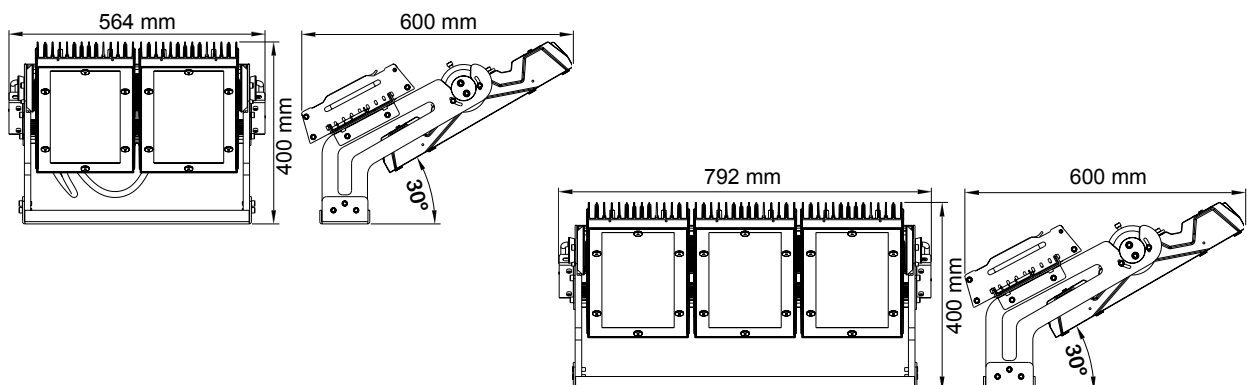

DIMENSIONS



CONSTRUCTION

- Die-cast aluminium body
- Powder coated finish
- Clear tempered glass diffuser
- Built-in surge protection device (10KV) for extra safety operation
- High efficiency SMD LED chips
- Built-in constant current non-dimmable LED driver
- High efficiency heat dissipation, light weight heatsink
- 40° module frame adjustable
- 70° individual module adjustable
- 1.1 m 3 core rubber flex

IP RATING

- IP66 weatherproof

FITTING COLOUR

- Black

COLOUR TEMPERATURE

- 5000K Neutral Daylight (standard)
- 3000K Warm White (option)
- 4000K Cool White (option)

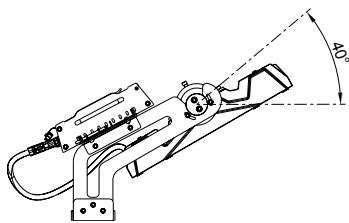

Module frame

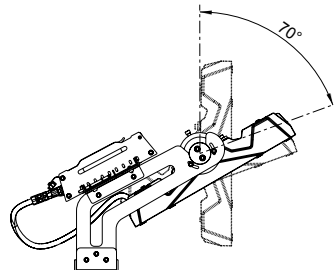

Individual module

Model No.	Input	Power	Lumen	CCT	Beam Angle	Beam Type	CRI	Net Weight
SE7100/6018	240V	600W	66,000lm	5000K	18°	Symmetrical	>80	28 kg
SE7100/6030	240V	600W	66,000lm	5000K	30°	Symmetrical	>80	28 kg
SE7100/6055	240V	600W	66,000lm	5000K	55°	Asymmetrical	>80	28 kg
SE7100/6155	240V	600W	66,000lm	5000K	155°	Asymmetrical	>80	28 kg
SE7100/9018	240V	900W	99,000lm	5000K	18°	Symmetrical	>80	40 kg
SE7100/9030	240V	900W	99,000lm	5000K	30°	Symmetrical	>80	40 kg
SE7100/9055	240V	900W	99,000lm	5000K	55°	Asymmetrical	>80	40 kg
SE7100/9155	240V	900W	99,000lm	5000K	155°	Asymmetrical	>80	40 kg

PHOTOMETRIC DATA UNIT: CD; C0/C180 — C90/C270 —

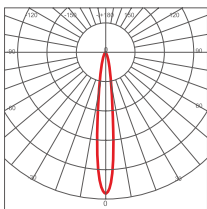

SE7100/6018
SE7100/9018

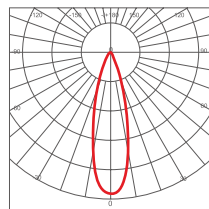

SE7100/6030
SE7100/9030

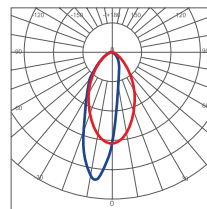

SE7100/6055
SE7100/9055

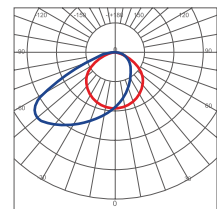

SE7100/6155
SE7100/9155